

ALL ALLOY
VERY HIGHEST 7075 GRADE



GENUINE KMAC... ALSO INCLUDES SEPARATE RADIAL THRUST BEARINGS FOR STEERING LOADS! PREVENT SPRING DRAG / BINDING

FULL RACE CAMBER & CASTER
Biggest Adjustment Range
 (NO FLEX -Tauter / Quicker response times, more effective shock control)

TRACK DAYS - Further reduce Negative Camber / Understeer
 Front lower arm inner "Camber" adjustable bushes (also includes thrust arm bushes to re adjust Caster - Mono ball / 2 axis improving brake & steering response) **#502616K**

- ✓ Fit (and adjust) with strut brace fitted
- ✓ Fit With or Without Adj. Coil Overs (60-70mm I.D.)
- ✓ Centers are Replaceable for virtual lifetime usage

RACE DAYS...
 Record separate settings (and Toe) for extra Neg. Camber. Significantly lowering of lap times through... Reduced understeer, Improved cornering, traction & braking response.

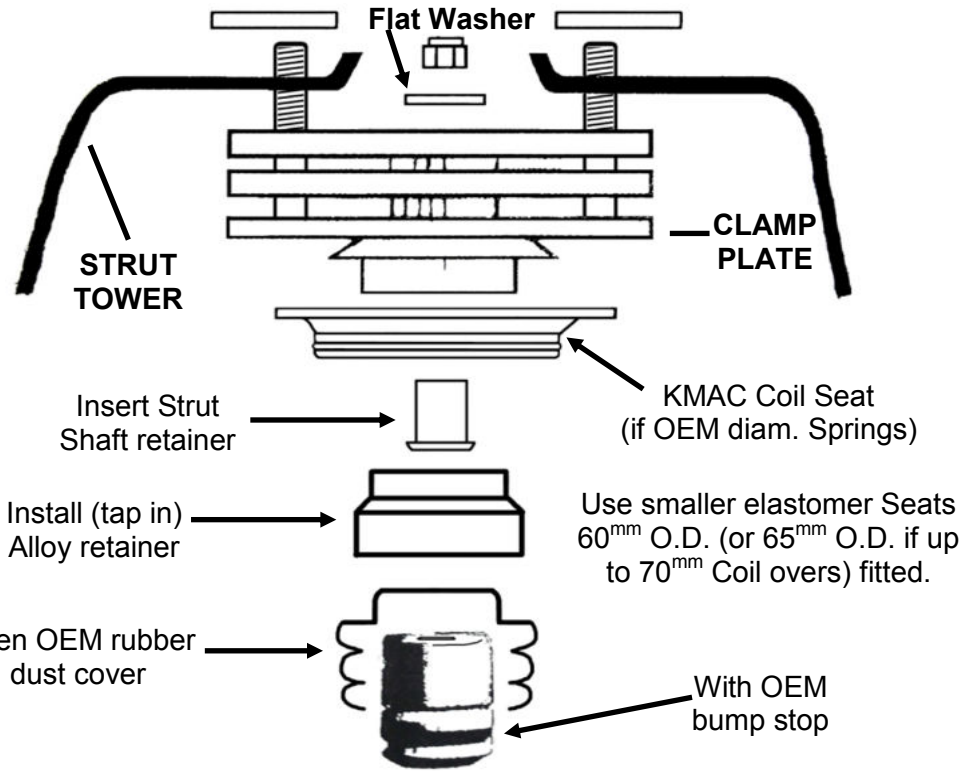

1. Kit (centers) are 'Left' and 'Right' hand offsets.
2. Can adjust for extra Positive or Negative Camber.
3. Below Diagram shows 'Centers' offset to rear (allowing also 'extra' Positive Caster adjustment).

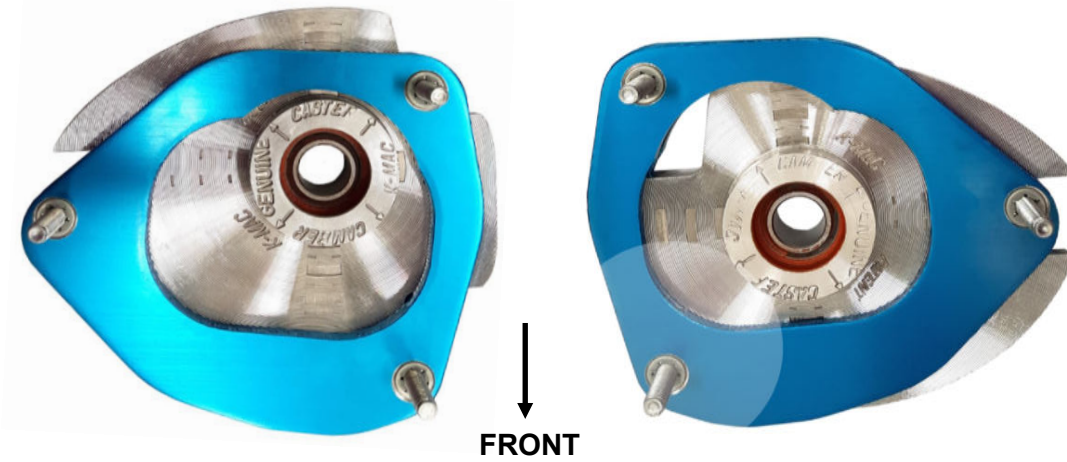

This side "OFFSET" for Extra Neg. Camber (and/or Pos. Caster)

This side showing "CENTER" position



FITTING

Simply replaces original strut 'upper' mounts
 (All items above Coil spring except for OEM dust cover and bump stop)

Refer manufacturer's workshop Manual re removal and installation
Observe all safety procedures

ALIGNING - NO NEED TO JACK TO ADJUST

- A. From Engine bay, loosen the '3' top mount nuts on strut tower.
- B. Use large screwdriver to lever / ratchet KMAC adjuster mount Crossways for Camber (rear to increase positive Caster).
- C. Once optimum setting obtained, tighten to **27Nm (20ft.lbs)**

© KMAC Align #502916-3



FRONT #502916-3L Stage 3 (FULL RACE)

W204/X, C207/A incl. AMG/BLACK series **COIL SPRING SUSPENSION**

FRONT CAMBER (and CASTER) FOR THE 1st TIME (and accurate-underload direct on alignment rack)

- ✓ **Biggest Adjustment** - Up to race winning 3^{0s} Neg. + 1.5 Pos.
Incl. "top coil seats" in OEM diam. & Coil overs (60-70 I.D.)
 - ✓ **Quickest Adjustment** - Change Camber & Caster settings - Street/Race from engine bay and with strut brace fitted - Massive 1 7/8" O.D.
 - ✓ **Centers extra H/Duty** - Self Align Spherical Bearings (PTFE Lined) with elastomer for extended wear life (Replaceable)
 - ✓ **Steering Loads** - Separate radial thrust bearings and preventing spring drag / binding
 - ✓ **KMAC not steel** - or soft billet alloy but ultimate
- **FRONT** - Also avail. lower arm bushings (Camber & Caster plus extra track width) and 2 axis / Mono Ball design to improve Brake and Steering response.
 - **REAR** - Also Camber (& extra Toe). Plus uprated bushings for the '6' multi link arms.

Always 1st With The Latest Design Breakthroughs

1. **WISHBONE:** Precise Ball Joint Adjustment System.
2. **STRUT(top):** Biggest/Quickest Adjustment System.
3. **BUSHINGS:** Single Wrench - Precise On Car Adjustment.

Including unique KMAC "non-slip" lock system!

Actual Inventors/Patentee's - The '3' Basic Suspension Systems

We do appreciate any ideas to further improve our market leadership !